

MAYSER®
Polymer Electric

Mayser Anti Trap Systems for power operated windows



- Very sensitive - short response time
- Independent of climatic influences
- Monitored for function and maintenance-free

Mayser Mini Safety Edges: Reliable Anti Trap Systems for power operated windows

Power operated windows and doors

Whether controlled natural ventilation, smoke and heat extraction or barrier-free access: modern building technology today is unimaginable without power operated facade components. Doors, windows and vents open and close by remote control. The automated control presents a constant danger of people getting trapped and injured.

Current guidelines and standards

Various guidelines and standards contain statements concerning the safety of power operated building elements according to the Directive 2006/42 EC on machinery. As far as windows are concerned, most of these guidelines are only partly applicable.

The KB.01 leaflet, version 2008-12, published by the Windows and Facades Manufacturers' Association VFF facilitates the implementation of suitable protective measures. A risk evaluation for power operated windows and measures to be taken for safeguarding them are depicted therein.

Depending on the design, configuration, use and position of the windows, it is, according to the KB.01 leaflet issued by the VFF, necessary to check if requirements from further guidelines and standards also apply.

Safety requirements are also referred to in the rules and standards of the national accident insurances companies, the BGR 232 document: In chapter 4.5, it states that "trapping and nipping points up to 2.5m in height must be made safe using equipment that, when touched or interrupted by a person, brings the moving action to a halt".

The guideline calls for safeguarding devices that ensure that the maximum trapping force of 150N is not exceeded: a challenge to the sensitivity of the Anti Trap Sensors, considering the weight involved in large windows and the correspondingly high drive forces of the automatic control.

Mayser Anti Trap Systems

Mayser Mini Safety Edges have been used as Anti Trap Sensors for several years now and have proven themselves in Automotive, Bus and Train, Medicine and Building Technology applications.

Outstanding advantages of tactile protection in comparison with other systems are the extremely short response time the sensors – which are monitored for function – have, as well as the constantly reliable switching function, which is independent of climatic influences, incidence of light and soiling.

The sensors are used in situations where little or no overtravel and minimum installation heights are possible. Whether louvre windows, parallel vent windows or tilt and turn windows, Mayser Mini Safety Edges can be fitted inconspicuously into various shear openings – depending on the window shape – making them safe. Reliably.

Application example louvre window

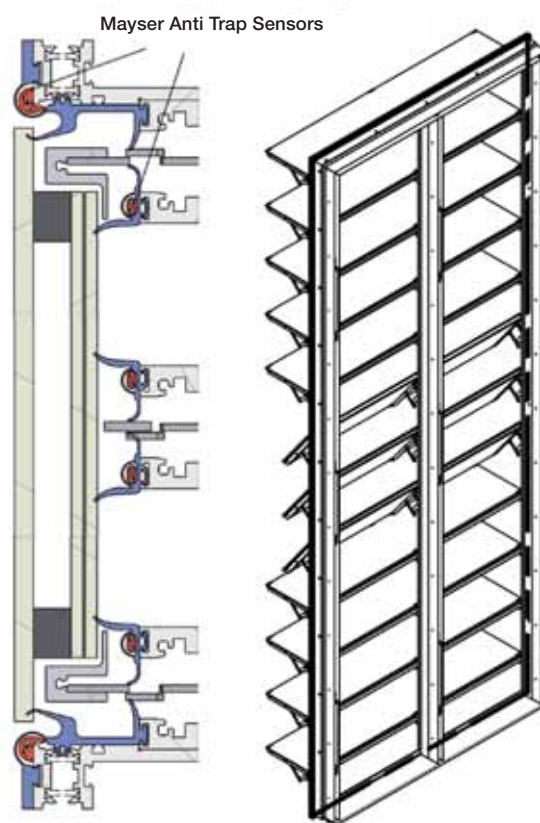

Mayser Anti Trap System overview:

- Proven use in Building, Medical and Automotive Technology
- Very sensitive – short response time
- Independent of climatic influences, incidence of light and soiling
- Maintenance-free and monitored for function

MAYSER®

Mayser GmbH & Co. KG
Polymer Electric
Örlinger Str. 1-3
89073 Ulm
GERMANY
Tel.: +49 731 2061-0
Fax: +49 731 2061-222
Internet: www.mayser.de
E-Mail: info.ulm@mayser.de